

金黄色铝壳电阻(Aluminum Housed Wirewound Precharge Resistors)RH/NH 5W-500W

高稳定,抗脉冲,电动汽车预充电、工控制动优选产品,可搭配散热器使用;

High stability, Anti-impulse, preferred products for electric vehicle precharge & industrial control braking.
Used with heat sink for better heat dissipation

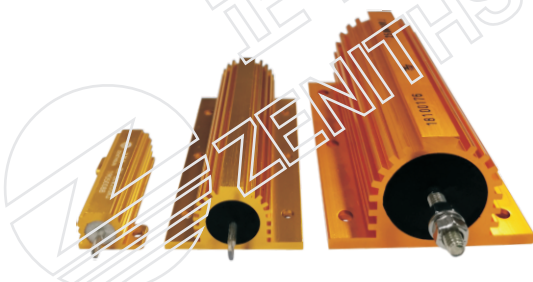

■ 结构 (Structure)

1. 核心电阻芯部件采用绝缘耐高温材料作为电阻骨架,选用高级优质合金丝均匀绕制,外加金属铝外壳,以高绝缘不燃性电子浆料进行灌封,使铝外壳与电阻核心部件紧密结合成一个坚实稳固的实体,不受外界空气、振动和灰尘影响,具有很高的稳固性和热传导性。

The resistors core components are made of insulating and high-temperature resistant materials as the resistors framework, evenly wound with high-quality alloy wires. Metal aluminum shell potted with high insulation non-combustible electronic paste, so that the aluminum shell and the resistance core components are closely combined into a solid entity, not affected by external air, vibration and dust, with high stability and thermal conductivity.

2. 铝外壳采用优质工业型6063铝材,并经过表面高温阳极处理,以达到更好的外观和散热效果。

The aluminum shell is made of high-quality industrial 6063 aluminum, and the surface is high-temperature anodized to achieve attractive appearance and great heat dissipation.

■ 特点(Features)

1. 精美型铝壳电阻。
Attractive appearance & easy installation.
2. 功率范围:5W-500W
Power Range:5W-500W
3. 具有高稳定、耐冲击、易安装;可靠性好,产品一致性高的特点。
High stability, impact resistance, good reliability & high consistency.
4. 引出端采用端把和螺栓式连接。
Ends outgoing: metal terminals or bolted connection.
5. 可供有电感RH或无感式NH(无感式感量偏低)。
Inductive or Non-inductive available.
6. 25W~50W常用于汽车LED灯行业。
50W, 100W, 250W常用于中频炉行业。
25W~50W used in automotive LED lamp industry.
50W, 100W & 250W used in medium frequency furnace industry.
7. 通常用于负载、制动、脉冲、充电、放电、启动、缓冲、泄放等场合。
Used for loading, braking, pulse, charging, discharging, starting, buffering, discharging, ect.

■ 适用范围 (Application)

深圳市正阳兴电子的系列铝壳电阻生产周期为2-3周,广泛用于变频器、电梯、起重、船舶、电力、焊接、电源、军工、航空、风力发电、太阳能发电、自动化设备、铁路系统等行业,并可以根据客户的需要,制作成电阻箱或电阻柜。

Production Time: 2-3 weeks. Widely used in frequency converter, elevator, hoisting, ship, electric power, welding, power supply, military industry, aviation, wind power generation, solar power generation, automation equipment, railway system and other industries, and can be made into load banks according to the customers requests.

■ 产品尺寸图表RH/NH 5W-500W (Dimension Chart)

RH/NH 5-10W引针式 (pins lead out)

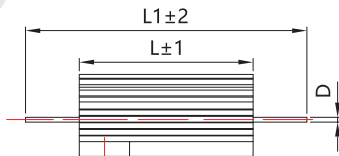

图一 (主视图)

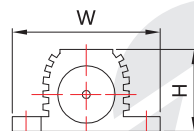

图二 (右视图)

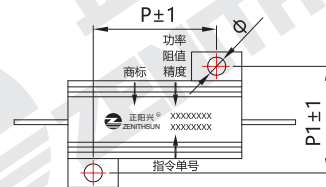

图三 (俯视图)

RH/NH 25-50W端把式 (solder lugs)

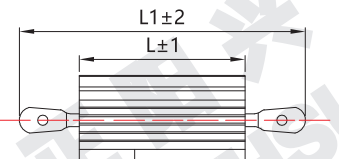

图一 (主视图)

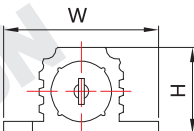

图二 (右视图)

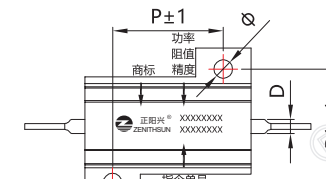

图三 (俯视图)

RH/NH 75-500W螺栓式 (bolt lead out)

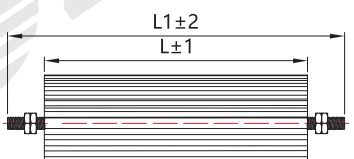

图一 (主视图)

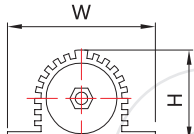

图二 (右视图)

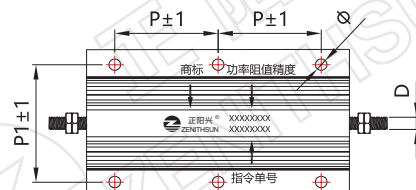

图三 (俯视图)

■ 产品尺寸图表RH/NH 100WT-250WT (Dimension Chart)

RH/NH 100WT 螺栓式 (bolt lead out)

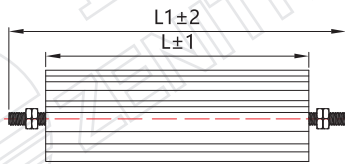

图一 (主视图)

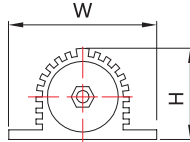

图二 (右视图)

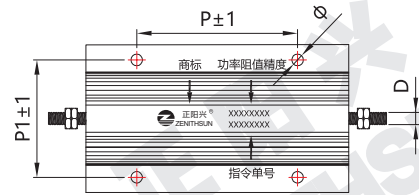

图三 (俯视图)

RH/NH 250WT 螺栓式 (bolt lead out)

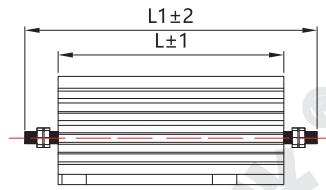

图一 (主视图)

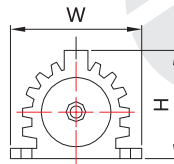

图二 (右视图)

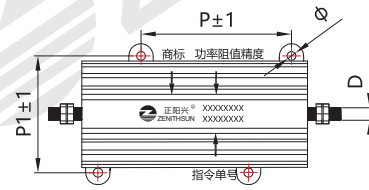

图三 (俯视图)

型号 Type	功率 Power	阻值范围 Resistance Range	精度 Tolerance	尺寸 Dimensions(mm)								净重(g) N.W	温度系数 T.C.R
				L1±2	L±1	W±0.5	H±0.5	P±1	P1±1	Φ±0.2	D±0.2		
RH/NH	5W	0.1Ω-100KΩ	J (±5%) G (±2%) F (±1%)	28.6	15.2	16.4	8.1	11.2	12.5	2.2	0.78	5	±100PPM ~ ±400PPM
	10W	0.1Ω-100KΩ		35	19.5	20.3	9.9	14.2	15.9	2.2	0.78	8	
	25W	0.1Ω-100KΩ		49	27	28	15.5	18.2	21.5	3.3	2.0	16	
	50W	0.5Ω-100KΩ		72	50	28	15.5	40	21.5	3.3	2.0	28	
	75W	0.5Ω-10KΩ		99.5	65.5	48	26	23.5	37	4.2	4	95	
	100Ws	0.5Ω-10KΩ		99.5	65.5	48	26	23.5	37	4.2	4	95	
	100W	0.5Ω-15KΩ		128	98	48	26	35	37	4.2	4	142	
	100WT	0.5Ω-27KΩ		129	89	73	45	70	58	6.5	6	370	
	150Ws	0.5Ω-15KΩ		128	98	48	26	35	37	4.2	4	142	
	150W	0.5Ω-22KΩ		165	135	48	26	52	37	4.2	4	200	
	200W	0.5Ω-22KΩ		185	155	48	26	63	37	4.8	4	230	
	250W	0.5Ω-33KΩ		152	112	73	45	45.5	58	5.5	6	460	
	250WT	0.5Ω-33KΩ		154	114	76	55.6	76	64	4.8	6	595	
	300W	0.5Ω-33KΩ		170	130	73	45	51.5	58	5.5	6	530	
500W	0.5Ω-33KΩ	244	204	73	45	87	58	5.5	6	830			

备注：如有特殊要求或者参数超出以上标准可协商供货，可作如下改变

1. 铝外壳尺寸; 2. 铝外壳颜色; 3. 安装孔大小; 4. 安装孔心距; 5. 引出端材质、线径及长度。

Note: other on requests are available: 1. Shell Dimensions; 2. Shells colour; 3. Installation holes size; 4. Installation holes distance;

5. Flying leads /Metal Terminals.

■ 定货示例 (How to order)

RH	250W	20R	J
↓	↓	↓	↓
系列 (NH为无感)	功率	标称阻值	精度 (J: ±5%, G: ±2%, F: ±1%)
Type (Non Inductive Resistor)	Power	Nominal value	Tolerance (J: ±5%, G: ±2%, F: ±1%)

■ 铝壳电阻性能实验参数 (Performance Characteristics)		
项目 Test	试验条件 Conditions of Test	性能要求 Testing Results
电阻值容许误差 Resistance Tolerance	测试电压≤3V,环境温度25°C Testing Voltage ≤3V, Ambient Temperature 25°C	F---G---J---K
温度系数 T.C.R	$\frac{R1-R0}{R0(T1-T0)} \times 10^6$ (PPM/°C) R0:常温(T0)下阻值 R0:Room Temperature(T0)Resistance R1:常温T0+100°C(T1)下阻值 R1:Room Temperature T0+100°C(T1)Resistance	±100PPM~ ±400PPM
额定负荷 Rated Load	40°C额定电压, 1小时 40°C, rated voltage, 1 hour	$\Delta R \leq \pm(3\%R + 0.1\Omega)$
短时间过负荷 Short Time Overload	5倍额定功率, 10秒; 10倍额定功率 5秒; 25倍额定功率 1秒 5 times rated power for 10s; 10 times rated power for 5s; 25 times rated power for 1s	$\Delta R \leq \pm(2\%R + 0.1\Omega)$
引出端对地绝缘耐压 Dielectric Withstand	0.8KV-4.5KVac 60秒,漏电流2.5mA 0.8KV-4.5KVac 60s, leakage current 2.5mA	$\Delta R \leq \pm(0.1\%R + 0.05\Omega)$
绝缘电阻值 Insulation Resistance	1000Vdc	50~1000MΩ, 1Min
引出端强度 Terminal Tensile Strength	引出端直径1.5以下20N,直径1.5以上40N,连接器端拉力20N Wire diameter ≤1.5 with 20N, wire diameter ≥1.5 with 40N, terminal tension 20N 端片式(铜端片/不锈钢端片)40N Copper end /stainless steel end, 40N	无脱落 No off
耐振性 Vibration resistance	1.5mm, 10-55-10Hz, 分别2小时 1.5mm, 10-55-10Hz, each 2 hours	无破损, 无脱落 No damage, No off
室温耐久性 Load Life	额定电压, 通电90分钟, 停30分钟, 共500小时 At rated voltage, 90 min "On", 30 min "Off", total 500 hours	$\Delta R \leq \pm(3\%R + 0.1\Omega)$
耐低温试验 Low Temp. Resistance	产品在-55°C±2°C环境条件下储存16H Store at -55 °C ± 2 °C for 16h	$\Delta R \leq \pm(1\%R + 0.1\Omega)$
耐高温试验 High Temp. Resistance	产品在70°C±2°C环境条件下储存16H Store at 70 °C ± 2 °C for 16h	$\Delta R \leq \pm(1\%R + 0.1\Omega)$
不燃性 Non-flammability	10倍额定功率, 通电5分钟 10 times rated power, power on for 5Min	允许开路, 但不燃烧 Without combustion

